



Honey Holme

Brixworth, Northamptonshire

oriordanbond
SALES & LETTINGS



Honey Holme

Brixworth
NN6 9BQ

GUIDE PRICE £230,000

This beautifully presented two double bedroom home with garage is located in a cul-de-sac position on the popular Froxhill development within the thriving village of Brixworth. The property has uPVC double glazing, gas radiator heating with a combination gas boiler and a modern kitchen with integrated appliances.

The accommodation comprises entrance porch with storage for shoes and coats, entrance hall with stairs rising to the first floor, sitting room with built-in under stairs storage cupboard housing the washing machine, kitchen/breakfast room with breakfast bar, integrated fridge/freezer, dishwasher, gas hob and oven and space for a freestanding tumble dryer and double doors to the rear garden. First floor landing leads to two double bedrooms and a modern bathroom with shower over the bath. Outside is an open plan front garden and a fully enclosed rear garden with gated rear pedestrian access. Communal parking is available both outside the front of the property and in the neighbouring close of Oathill Close (18 meters away from the property) where the garage can also be located in a block. (A/660/M)

Additional information

- Council Tax Band: B
- Energy Efficiency Rating: C

Viewing

Viewing strictly by appointment – details below

Disclaimer

O’Riordan Bond Estate Agents Limited has not tested apparatus, equipment, fittings or services and so cannot verify they are in working order. The buyer is advised to obtain verification from their solicitor or surveyor.

O’Riordan Bond Brixworth Sales
01604 880077

brixworth@oriordanbond.co.uk

GROUND FLOOR
336 sq.ft. (31.2 sq.m.) approx.

1ST FLOOR
324 sq.ft. (30.1 sq.m.) approx.

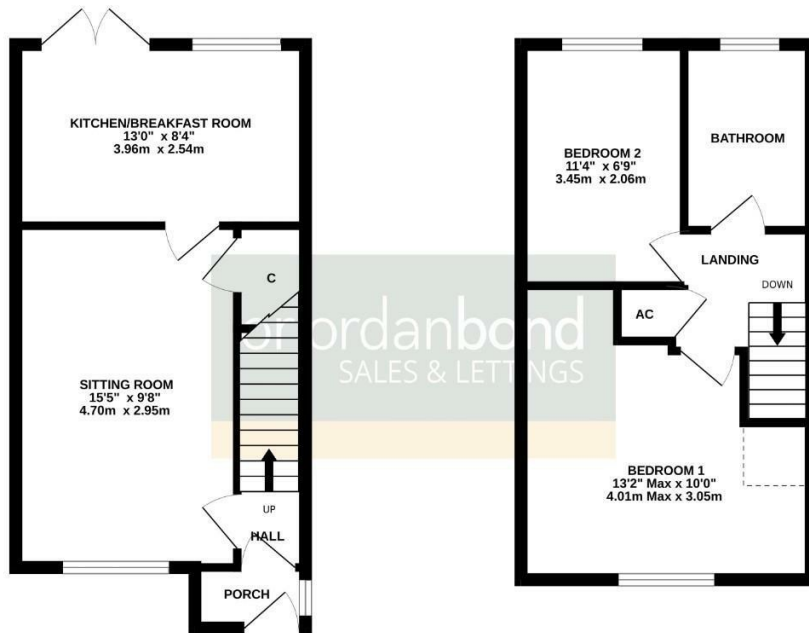

TOTAL FLOOR AREA : 660 sq.ft. (61.3 sq.m.) approx.

While every attempt has been made to ensure the accuracy of the floorplan contained here, measurements of doors, windows, rooms and any other items are approximate and no responsibility is taken for any error, omission or mis-statement. This plan is for illustrative purposes only and should be used as such by any prospective purchaser. The services, systems and appliances shown have not been tested and no guarantee as to their operability or efficiency can be given. Made with Metrepro. ©2020.

